

Tools: 9/16" wrench, torque wrench with 9/16" socket, power drill with 3/8" bit, and a C-clamp. If using bolts to tap/thread holes, add 11/32" bit and a ratchet.

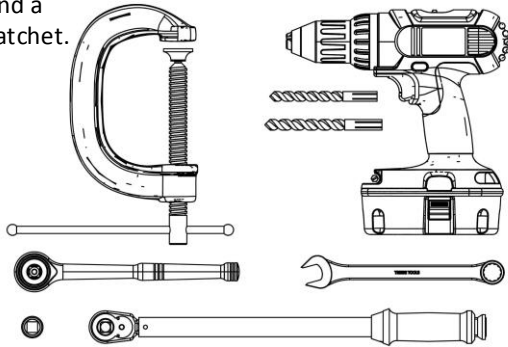

Included Parts

2 - SafetyStruts™
6 - Self-Tapping Bolts
6 - Flanged Locknuts

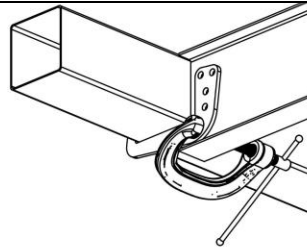

SQUARE BUMPER EXAMPLE USING 6 INCH I-BEAM FRAME



REAR FACE

BOTTOM FACE



NOTE: This gap is intentional and exists to allow room for the weld holding the bumper to the frame.

Step 1: Position the SafetyStruts™ tight against the rear face and bottom face of the bumper (arrows above) and then securely clamp it in place (as shown at left) against vertical surface of frame. Part will be used as a drill guide in the subsequent steps below.

FASTEN PARTS USING ONLY SELF-TAPPING BOLTS (STB)*



Step 2 (STB): Select the 3 widest-spaced, unobstructed holes in the part. Then use the 3/8" bit to drill *slightly* into the steel (just to mark the hole centers).

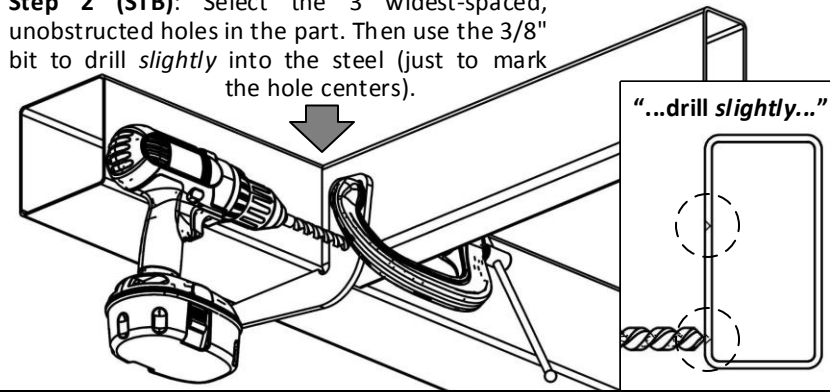

Step 3 (STB): Using the 11/32" bit, drill the holes completely through using the dimples made with the 3/8" bit as a guide. **Note: Use only an 11/32" drill bit for this step!**

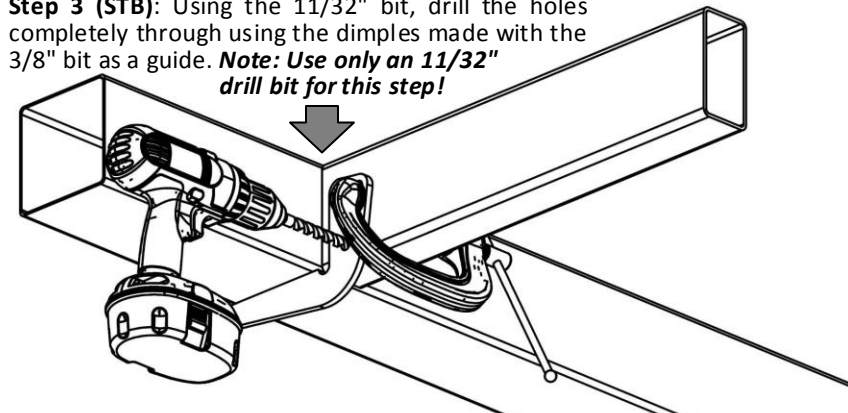

Step 4 (STB): Screw bolts *slowly* into the 11/32" holes using the ratchet and 9/16" socket, pressing in as you turn. **Caution: Do not over-tighten!**

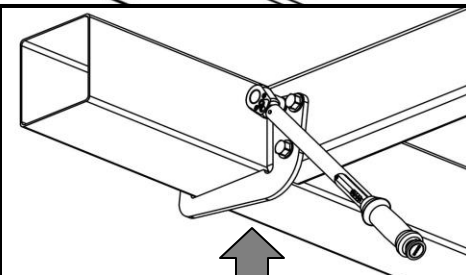
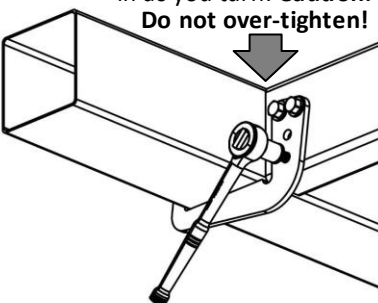

Step 5 (STB): Final Step! Using the torque wrench, slowly tighten bolts to **15-20 ft. lbs.** *Tighten carefully! Over-torquing will strip threads.*

FASTEN PARTS USING NUTS AND BOLTS (N&B)*

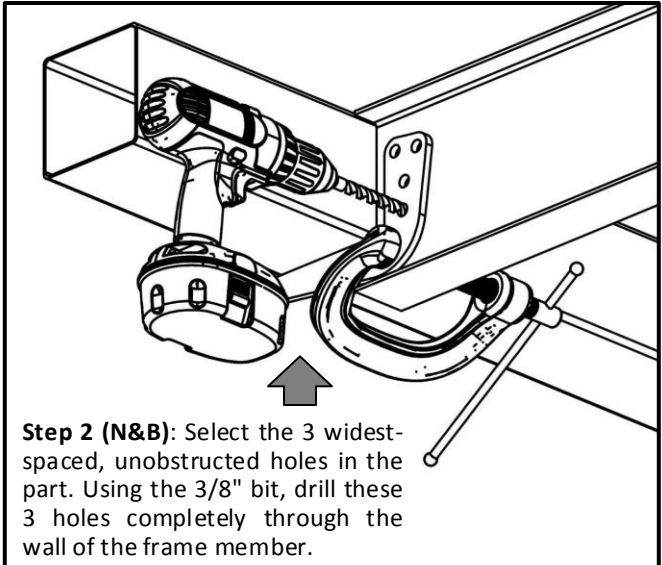

Step 2 (N&B): Select the 3 widest-spaced, unobstructed holes in the part. Using the 3/8" bit, drill these 3 holes completely through the wall of the frame member.

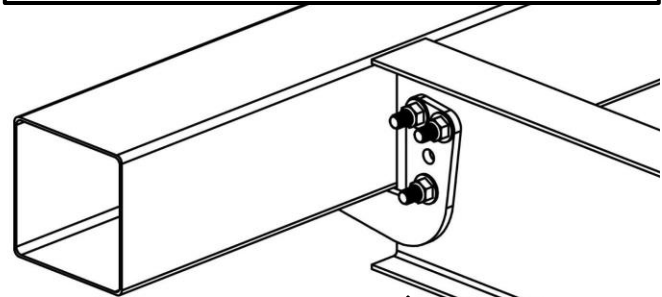

Step 3 (N&B): Final Step! Attach the SafetyStruts™ to your vehicle's frame using the supplied nuts and bolts. Use a torque wrench to slowly tighten the nuts and bolts to **15-20 ft. lbs.**

* **Self-Tapping Bolts (STB)** are for use on 0.120" (~1/8") or thicker steel. Use **Nuts and Bolts (N&B)** on 0.188" (3/16") or thinner steel. *Most frames are 0.120" or thicker.*

Visit www.mount-n-lock.com/installs
for full-size instructions.

Tools: 9/16" wrench, torque wrench and ratchet with 9/16" socket, power drill with 5/16" and 3/8" bits, and a C-clamp.

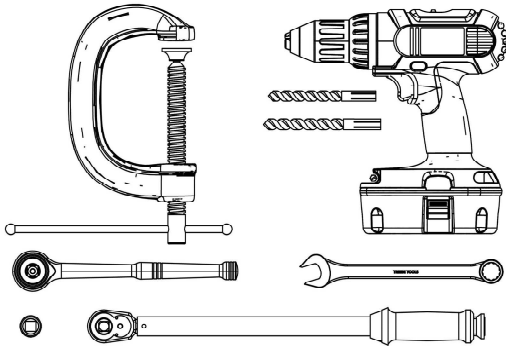

Parts List:

2 - SafetyStruts™ Brackets
12 - 3/8"-16 x 3/4" Flange Bolts
6 - 1-3/4" Standoff Spacers

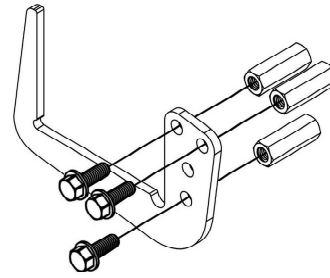

SQUARE BUMPER

EXAMPLE USING 4 INCH I-BEAM FRAME

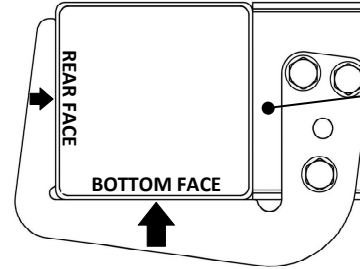

NOTE: This gap is intentional and exists to allow room for the weld holding the bumper to the frame.

NOTE: Bottom of bumper must be flush with bottom of 4" frame to fit spacers.

Step 1: Attach Standoff Spacers to SafetyStruts™ using Flange Bolts as shown at left. Next, position the assembly tight against the rear face and bottom face of the bumper (arrows above) and against frame.

Step 2

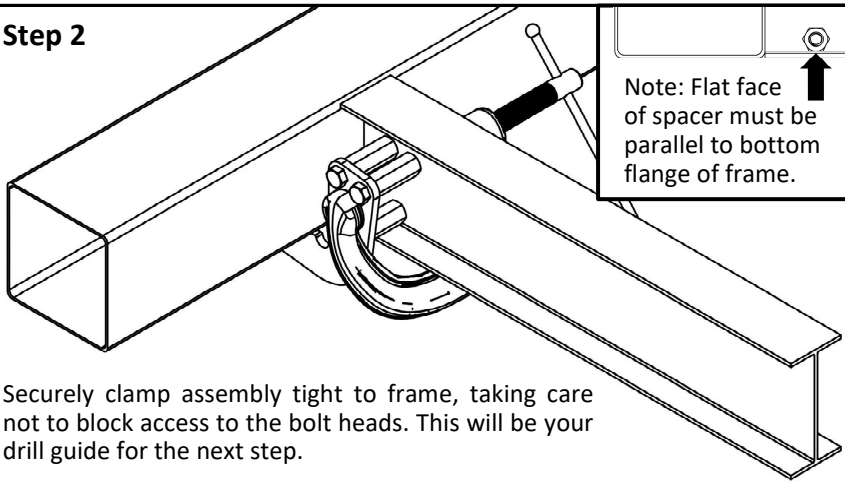

Securely clamp assembly tight to frame, taking care not to block access to the bolt heads. This will be your drill guide for the next step.

Step 3

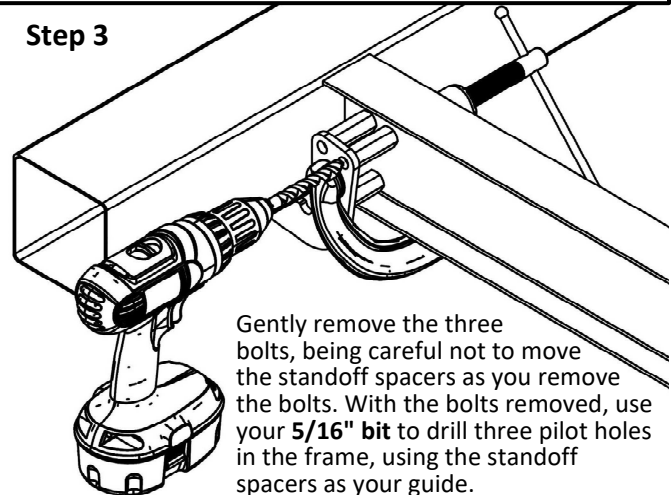

Step 4

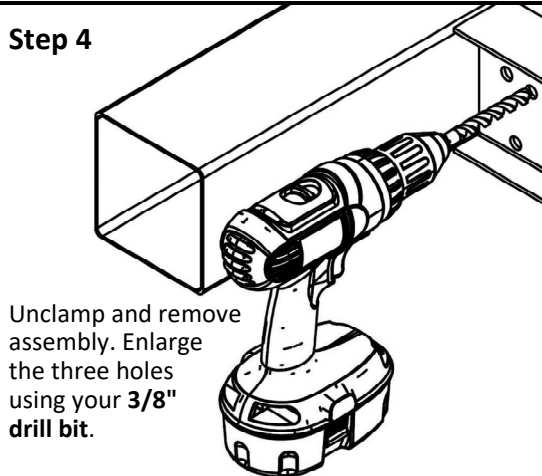

Step 5

Fasten SafetyStruts™ to the standoff spacers and the standoff spacers to the frame as shown.

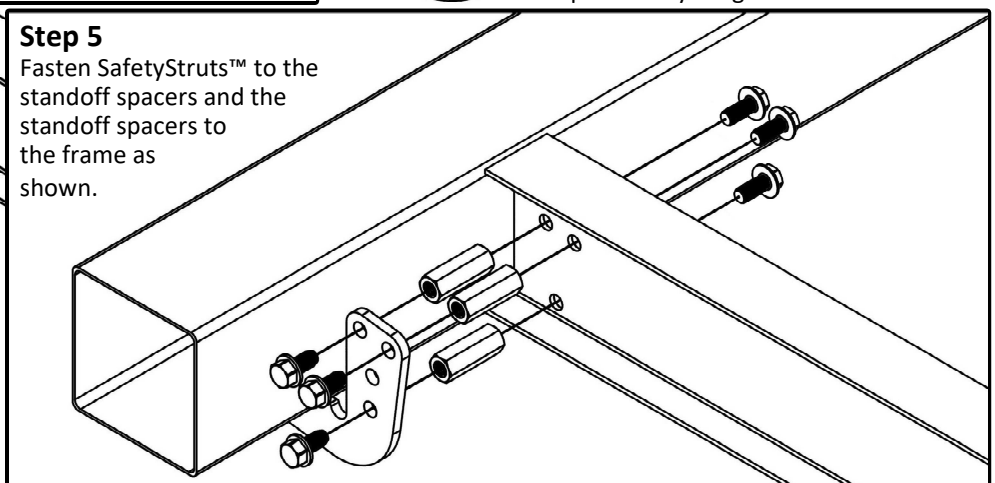

Step 6A

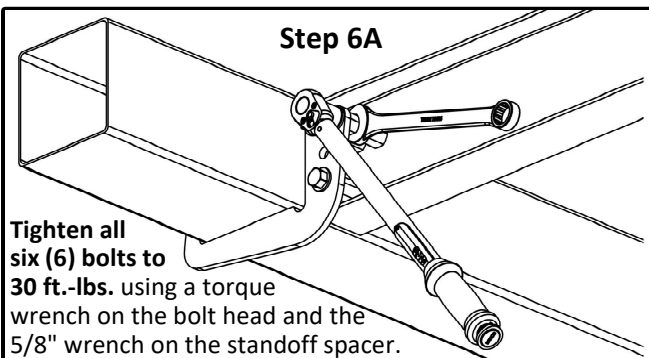

Step 6B

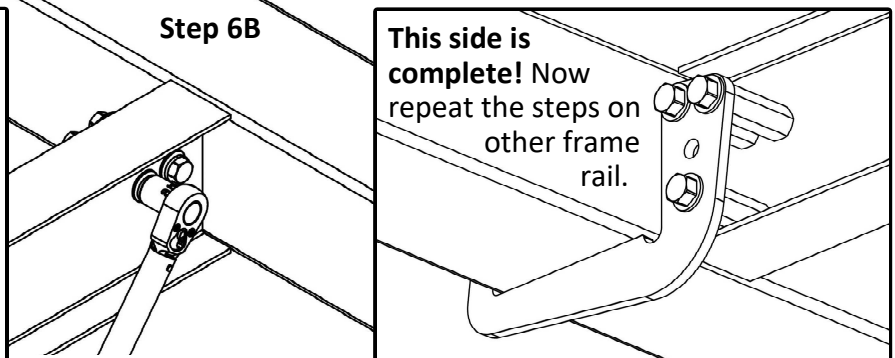

This side is complete! Now repeat the steps on other frame rail.

Visit www.mount-n-lock.com/installs for full-size instructions.

© Copyright 2017 BetterBilt Solutions LLC. All Rights Reserved. Patents Pending.

Tools: 9/16" wrench, torque wrench with 9/16" socket, power drill with 3/8" bit, and a C-clamp. If using bolts to tap/thread holes, add 11/32" bit and a ratchet.

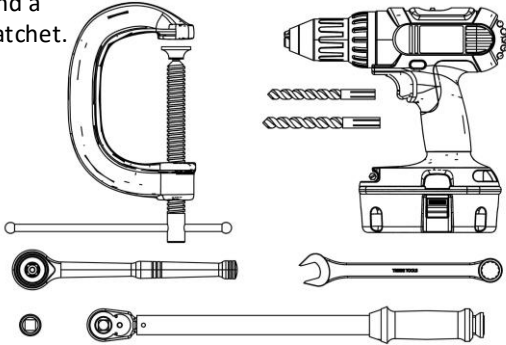

Included Parts

2 - SafetyStrutsTM
6 - Self-Tapping Bolts
6 - Flanged Locknuts

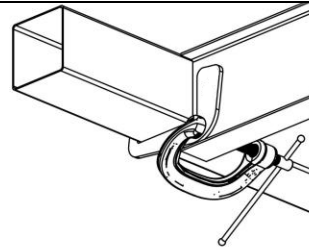

SQUARE BUMPER EXAMPLE USING 6 INCH I-BEAM FRAME

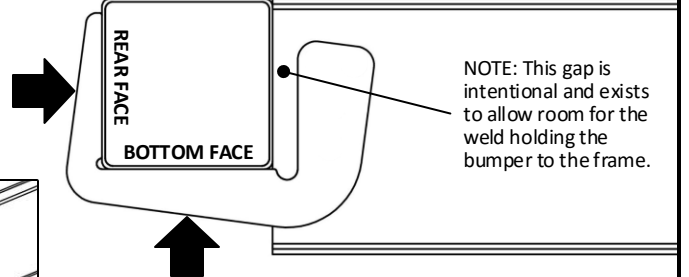

Step 1: Position the SafetyStrutsTM tight against the rear face and bottom face of the bumper (arrows above) and then securely clamp it in place (as shown at left) against vertical surface of frame. Part will be used as a drill guide in the subsequent steps below.

FASTEN PARTS USING ONLY SELF-TAPPING BOLTS (STB)*



Step 2 (STB): Use the 11/32" bit to drill three well-spaced holes through the part and through the frame wall. Remove the part and drill out the holes in the part using the 3/8" bit. *Do NOT drill out the holes in the frame.*

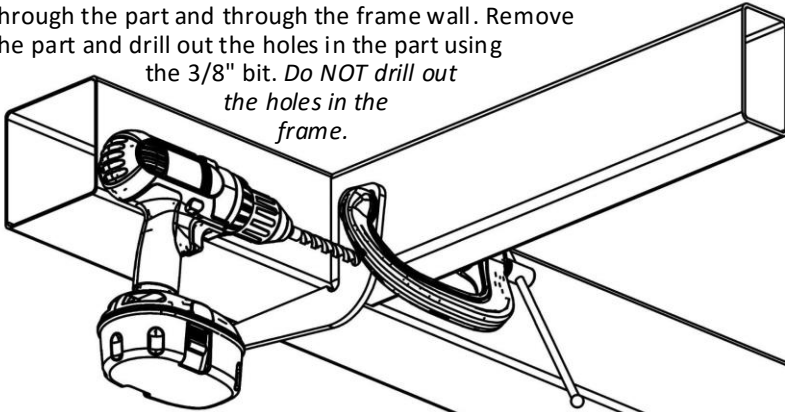

Step 3 (STB): Screw bolts *slowly* into the 11/32" holes using the ratchet and 9/16" socket, pressing in as you turn. **Caution: Do not over-tighten!**

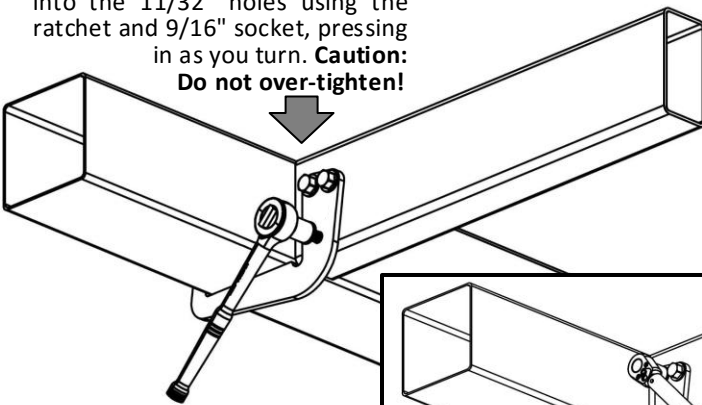

* **Self-Tapping Bolts (STB)** are for use on 0.120" (~1/8") or thicker steel. Use **Nuts and Bolts (N&B)** on 0.188" (3/16") or thinner steel (due to bolt length). Most frames are 0.120" or thicker.

Step 4 (STB): Final Step! Using the torque wrench, slowly tighten bolts to **15-20 ft. lbs.** *Tighten carefully! Over-torquing will strip threads.*

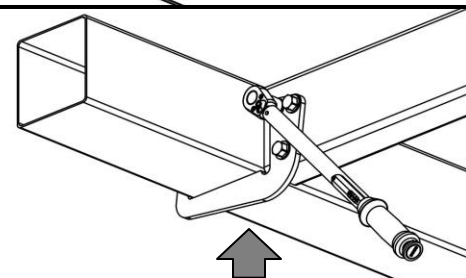

FASTEN PARTS USING NUTS AND BOLTS (N&B)*

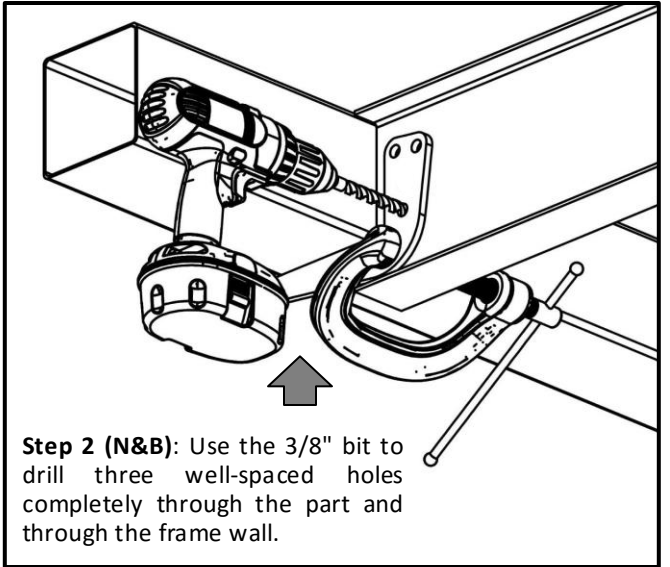

Step 2 (N&B): Use the 3/8" bit to drill three well-spaced holes completely through the part and through the frame wall.

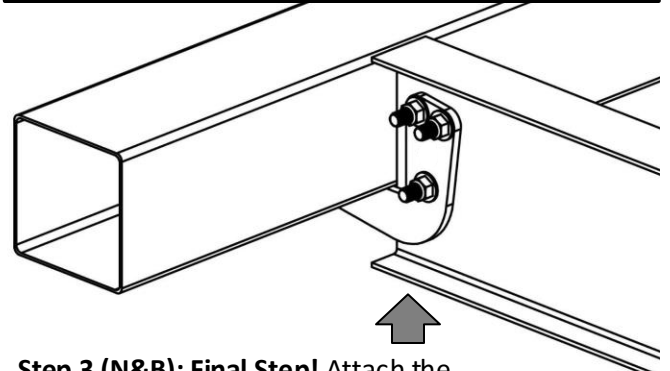

Step 3 (N&B): Final Step! Attach the SafetyStrutsTM to your vehicle's frame using the supplied nuts and bolts. Use a torque wrench to slowly tighten the nuts and bolts to **15-20 ft. lbs.**

Visit www.mount-n-lock.com/installs for full-size instructions.